

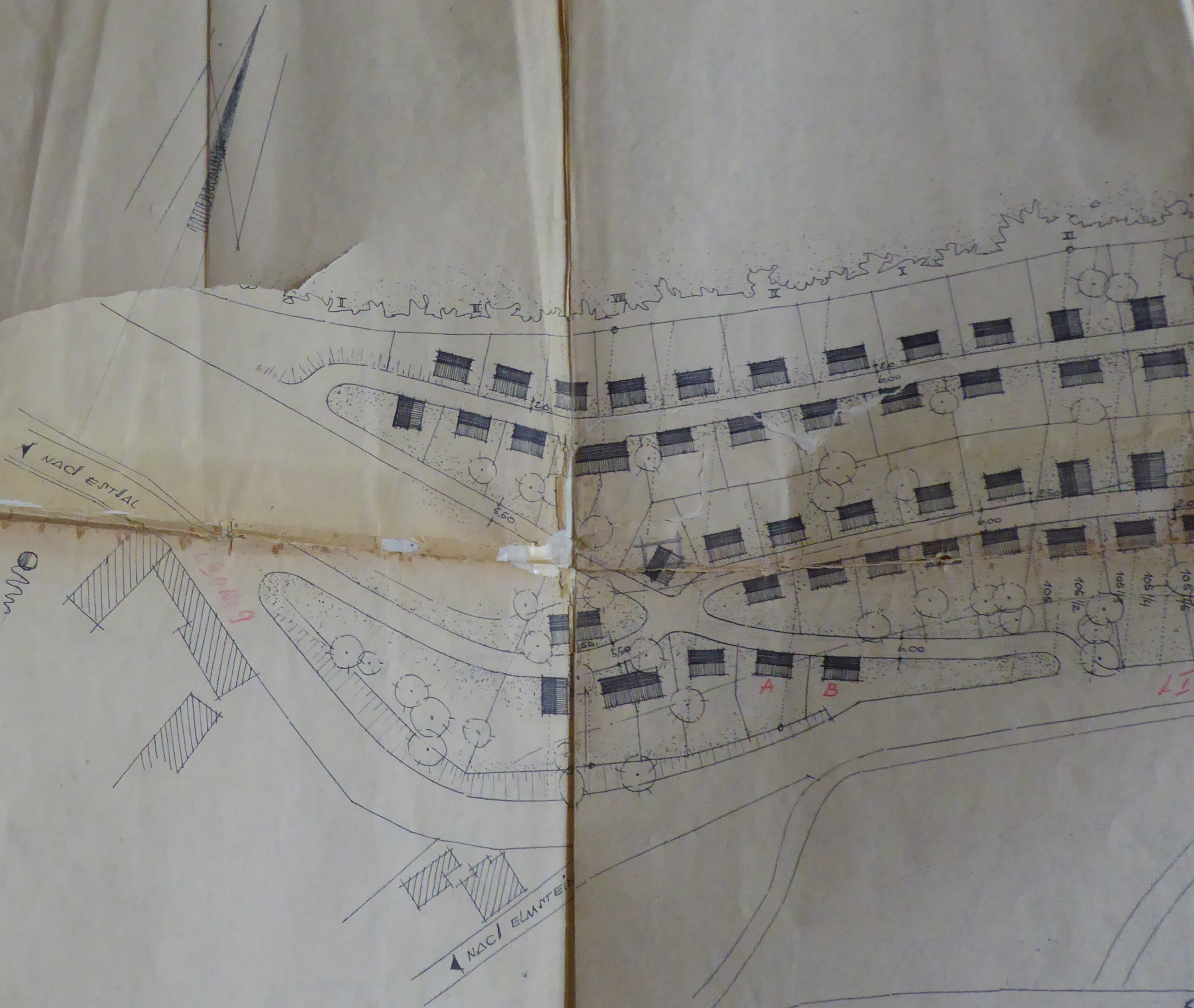



Frankeneck

BEBAUUNGSPLAN:
REMANNE, MÜTZLER-BERG
M A N T A B, 1:1000

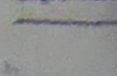
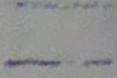

ERKLÄRUNGEN:

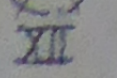
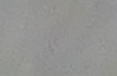
-  GEPLANTE BAUTEN
-  BESTEHENDE GEBÄUDE
-  NEUE GRENZEN
-  AUFGELÖBENE GRENZEN
-  HÖHENLINIEN
-  BÄUME U. STRÄUCHER
-  GELÄNDEQUERSCHNITTE

FRANKENECK DEN 7. JULI 1953.
DER BÜRGERMEISTER:



Grunni